

AERODROME CHART - ICAO	ARP: 12° 11' 20.09" N 068° 57' 34.89" W	AERODROME ELEV: 36' 11.1m APRON ELEV: 27' 8.2m	CURAÇAO CTRL 124.1/127.1 CURAÇAO TRACON 119.8 HATO TWR 118.3 HATO ATIS 132.6	AEROPUERTO HATO (TNCC) WILLEMSTAD, CURAÇAO
------------------------	--	---	---	---

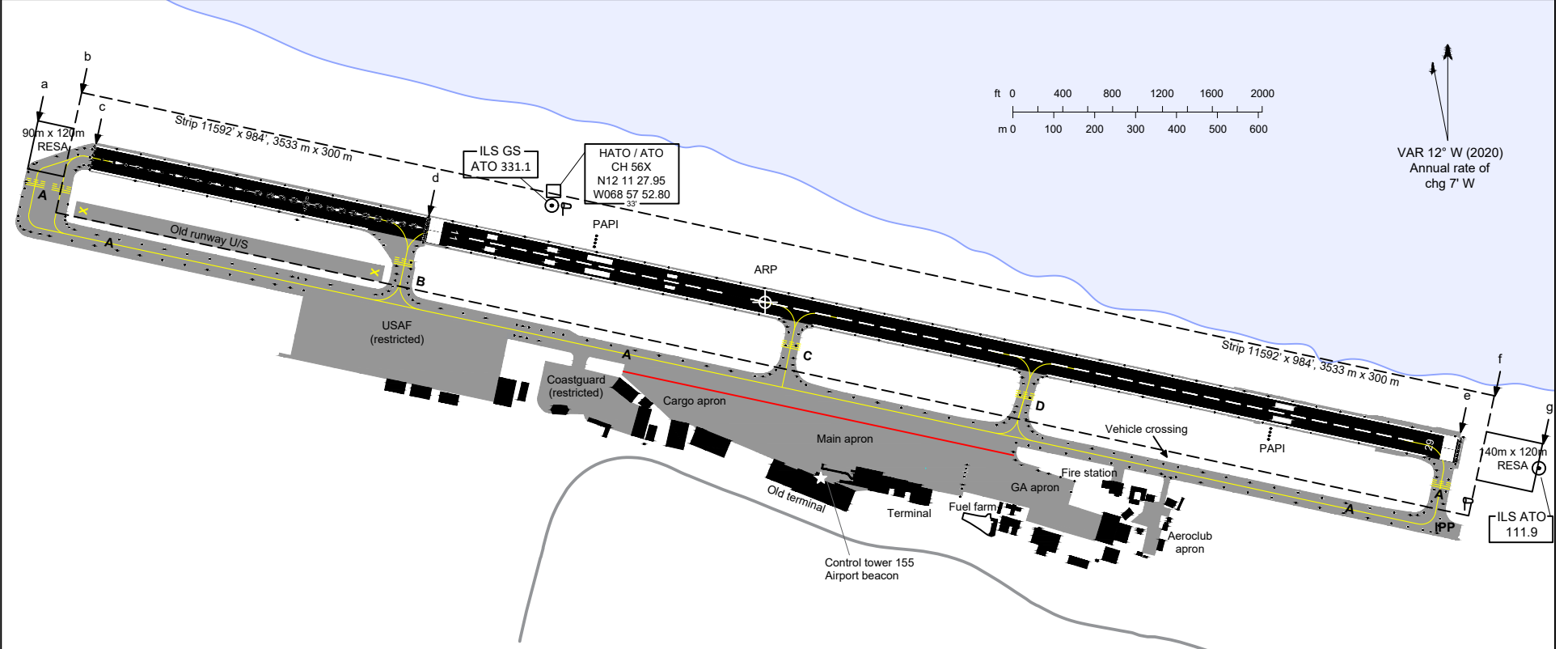

- NOTES**
- Left turn mandatory for RWY 11 departures unless ATC has approved right turn.
  - Jet aircraft departing RWY 11 with approved right turn shall proceed on RWY heading for at least 2 min or until reaching FL 030, whichever is earlier, before turning on course.
  - Overflying oil refinery and installations below 2500 ft AMSL is prohibited.
  - At night after last scheduled flight, RWY and TWY lights are turned off. In case of emergency contact Hato Tower on 118.3 MHz.
  - RWY 29 right hand traffic.
  - Birds in vicinity of airport.
  - An approved ground handler must be used for payment of landing and parking fees (see FAL section).
  - Immigration and Customs are not available 24 hours/day.
  - Altitudes and elevations in feet and meters, distances in feet and meters, bearings are magnetic.

**RUNWAY DISTANCES**

a - b =	295'	90 m
b - c =	197'	60 m
c - d =	2739'	835 m
d - e =	8459'	2578 m
e - f =	197'	60 m
f - g =	459'	140 m

**RWY/TWY WIDTHS**

RWY	197'	60m
TWY	75'	23m

**SURFACE / STRENGTH**

RWY	Asphalt/concrete	60 F/A/W/T
TWY	Asphalt/concrete	60 F/A/W/T
Main apron	Asphalt/concrete	See note 1
Auxiliary aprons	Asphalt	45,500 kg AUW

Note 1 - 85 (wet season), 28,021 kg SIWL at 11.96 kg/cm<sup>2</sup> (170 lbs/square inch) ground contact pressure

**LEGEND**

Aerodrome Ref Point (ARP)	⊕
Windsock	⊙
Navaid	⊙
Lights	●●●
Airport Rotating Beacon	★
Building	■
Ramp, taxiway	▨
Taxi holding position	▬▬▬
ATC service boundary	—

\* RWY 11: Red prior to displaced threshold, white after displaced threshold except yellow last 600 m.

RWY	TORA	TODA	ASDA	LDA	Start of TORA/TODA/ASDA	Point	Elev	Start of LDA	Point	Elev	Lighting	Bearing
11	11198' (3413 m) (c-e)	11198' (3413 m) (c-e)	11198' (3413 m) (c-e)	8459' (2578 m) (d-e)	N12 11 31.73 W068 58 30.09	c	32' (9.8 m)	N12 11 26.05 W068 58 03.08	d	32' (9.8 m)	Simple approach lights (embedded), RWY THR ident lights, high intensity RWY edge lights*, PAPI-L 3.00', green THR lights, red end lights.	114°
29	11198' (3413 m) (e-c)	11198' (3413 m) (e-c)	11198' (3413 m) (e-c)	11198' (3413 m) (e-c)	N12 11 08.46 W068 56 39.69	e	36'(11.1 m)	N12 11 08.46 W068 56 39.69	e	36'(11.1 m)	High intensity RWY edge lights (white except yellow last 600 m), PAPI-L 3.00', green THR lights, red end lights.	294°

CHANGES: New chart